



The CalSealed waterproofing system for 22mm internal diameter tie-bolt tubes

1. CalSealed products

1.1 There are three components to this system, a water-reactive 'Collar' which goes around the tie-bolt tube,



1.2 a 'Plug with a water-reactive section which is inserted into each end of the tie-bolt tube and

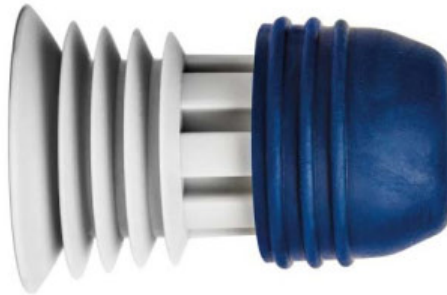

1.3 Calplug waterproof mortar for infilling the rebate.

2. Installation instruction:

2.1 Overview

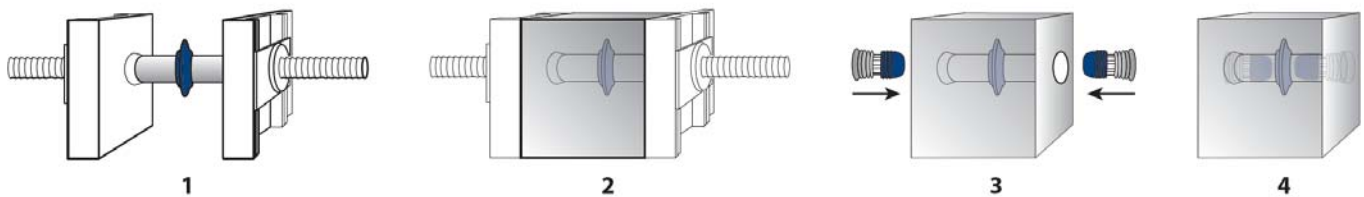

2.2 Place 'Collar' centrally around the pre-cut tie-bolt tube and install the tube.



- 2.3 Insertion of plugs. Following placement of the concrete and subsequent striking of the formwork, remove the plastic cone from each end of the tie-bolt tube, remove any residue of concrete that may have entered the tube and then insert 'Plugs' into the holes and tap into place with a hammer.

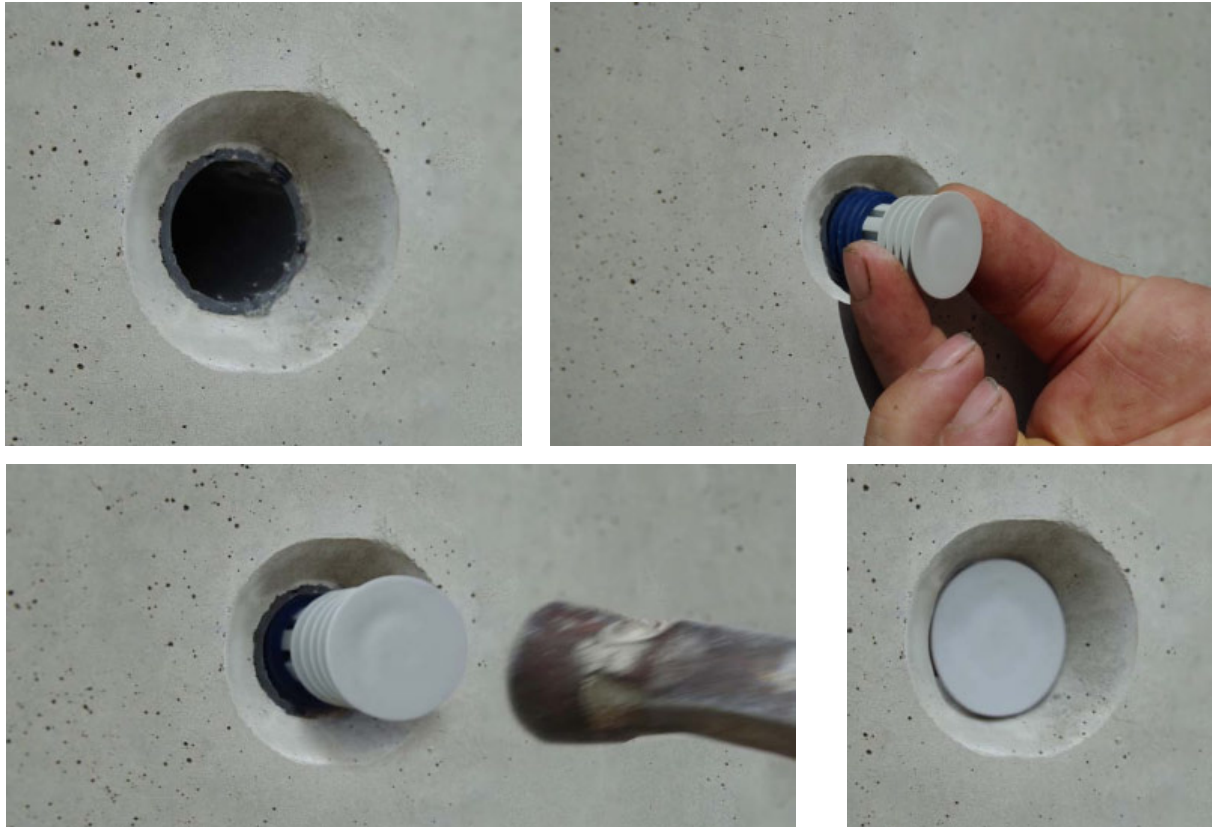

- 2.4 Finally, the section where the Dividag cone has been removed needs to be neatly filled to profile with Calplug Mortar.
3. The tube 'Collars' are supplied in bags of 50 and the 'Plugs' in bags of 100.



CEMENTAID

Cementaid (UK) Limited, 1 Baird Close Crawley, RH10 9SY. Tel: 01293-653900
info@cementaid.co.uk